

HOLDEN JACKAROO/RODEO CLUTCH RELEASE ISSUES

Poor release and pedal feel is common in the pull-type clutches fitted to these vehicles. In most cases this can be attributed to the operating mechanism rather than the clutch itself. These issues are more prevalent in older and high mileage vehicles. Wear in any of these mechanisms can create an uneven or notchy pedal feel and restrict the clutch release.

When replacing the clutch in these vehicles thoroughly inspect the following areas:

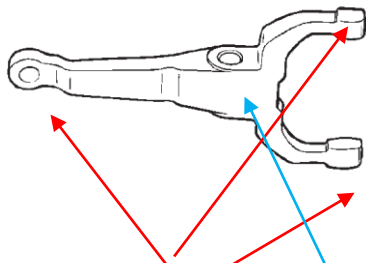

Release Fork & Bushings

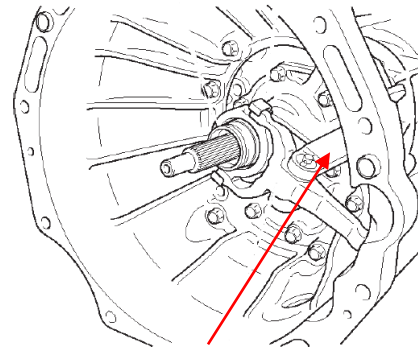

Fork Shaft

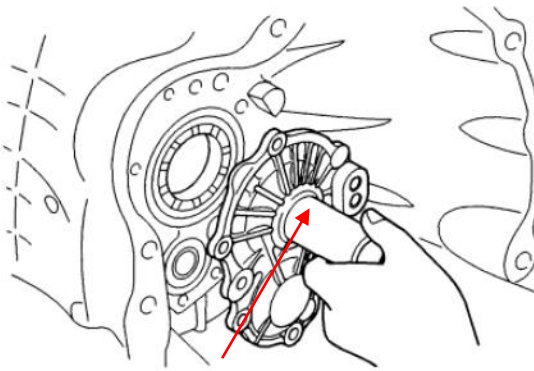

Gearbox Nose Cone

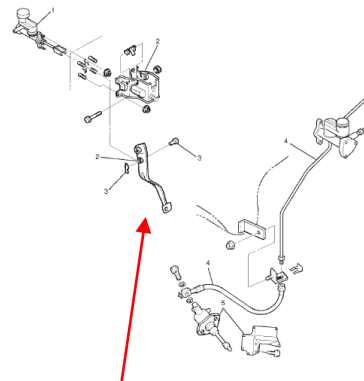

Pedal Bushings & Hydraulics

If any wear is present in these areas it is recommended that they be replaced before the installation of the new clutch is performed.

!! THE CLUTCH FORK CAN BE FITTED BACK TO FRONT SO TAKE CARE IN RE ASSEMBLY !!