

POOR CLUTCH RELEASE – 4JB1T RODEO

These vehicles have been fitted with a Clutch Damper which locates between the Clutch Master Cylinder and Slave Cylinder. The Clutch Damper has been found to be the cause of these vehicles experiencing disengagement issues which has been incorrectly diagnosed as a faulty clutch.

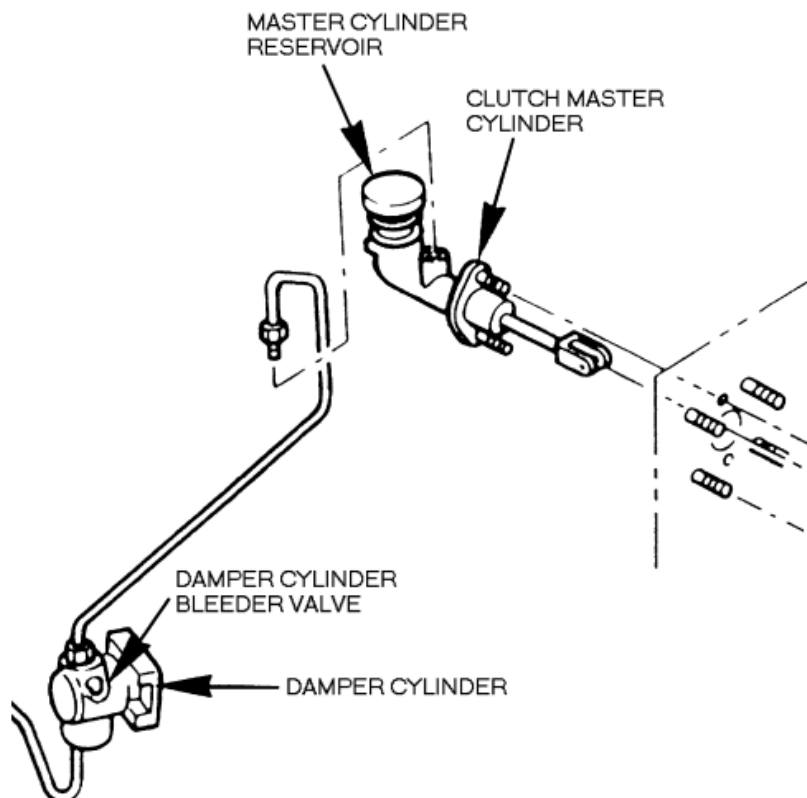

This image is for illustration purposes only and is not reflective of the actual damper fitted to the vehicle.

The damper could have either the fluid bypassing the cup or the rubber compressing which restricts the fluid flow.

To test if the damper is at fault first bypass the damper with the use of a hydraulic line directly to the slave cylinder from the master. Then operate the clutch in the vehicle to ascertain whether it is working as it should. The damper is a required component and should be replaced if this is found to be the problem rather than bypassing the unit.